



14

P AND Z CONSTRUCTION, LLC

211 North 93rd Avenue - Yakima, WA

Yakima Area - Category A



Steve Zerr & Darin Peters
509.577.1535

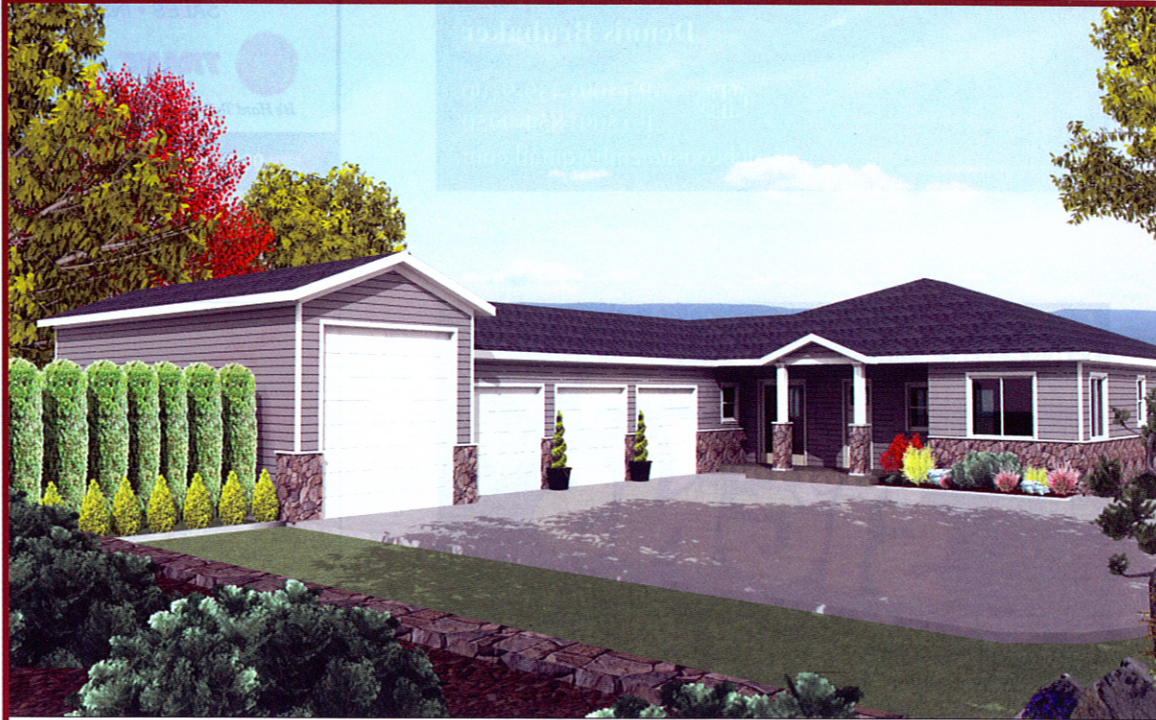

P and Z Construction, LLC and TANNA BY DESIGN would like to invite you to tour our custom designed home. This exquisite floorplan offers a comfortable and elegant space which is loaded with unique designs and practical features. Upon entry to the home, you will immediately be exposed to the superb craftsmanship and mid-century modern style. This home is characterized by simplicity and natural shapes, emphasized by ample windows, an open floorplan and the idea of bringing the outdoors in. The lighting design creates stunning reflections with the use of mirrors, accessories and dimming options throughout.

Overall, the home has 3,564 square feet of space to live, dine, bathe and sleep. This well thought out home has four bedrooms plus a private guest room/den with separate entry. Add-ons include a security system, sound system, central vacuum and cable connection in every room. The day-light basement design has three and a half baths, a main floor great room, chef's kitchen complete with stainless steel appliances, customized concrete countertops by *Quinel Construction* and a stainless steel island and eating bar that seats eight by *ASAP Sheet Metal*. The espresso stained, solid shaker style custom cabinets by *Creative Cabinet Designs* provide a gorgeous backdrop and an abundance of space including a built-in china cabinet and wine bar. Powder coated steel railing with stainless steel cables by *The Welding Place* lead you down the lit stairs to the entertainment room which also offers an additional laundry room and a locked cellar. On the exterior are two large covered patios, an oversized swimming pool and a large outdoor sports activity area

by *C & S Pool and Gil Concrete*. The unique landscape sets the custom tone as you arrive. An oversized, four-car, heated garage includes window viewing electric doors with a fifth door opening to a backyard washing pad. The last bay will house a 40-foot recreational vehicle with draining amenities.

P and Z Construction, LLC is a custom home builder that has been in business in the Yakima Valley since 1994. We strive to build relationships with our customers, making constructing a new home one of the most enjoyable experiences of your life. We take great pride in our craftsmanship, quality and care for the products that we install in your home. *Darin and Steve* would like to thank *Traditional Designs*, TANNA BY DESIGN, our subcontractors, *Selah National Bank* and everyone involved in making this project another success for P and Z Construction, LLC.

Tanna Barnecut is the proprietor of TANNA BY DESIGN. *Tanna's* passion for interior design is reflected in the beautiful surroundings that she creates. An ability to collaborate with architects, contractors, and her clients have earned *Tanna* a well deserved reputation as a true professional.

Equally, TANNA BY DESIGN would like to thank Brad and *Traditional Designs* for bringing their floorplan drawing to life, all of the sub-contractors for their ability to wrap their craft around our ideas and P and Z Construction, LLC for their overall extraordinary Project Management and unmatched construction expertise.

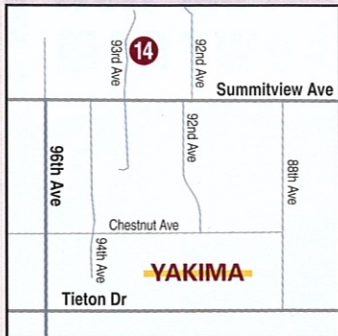

Take Summitview Avenue west from Yakima. Turn right on North 93rd Avenue. The home is located at 211 North 93rd Avenue.

MAIN LEVEL

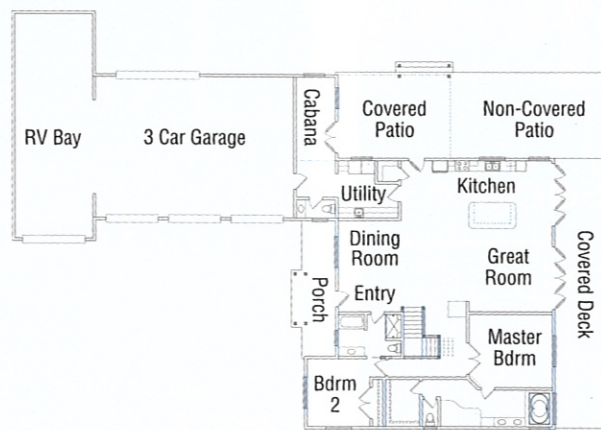

LOWER LEVEL

