

# Harris Construction

# 11

Category A

620 Shannon Rd. | Yakima

Lynn and Keegan Harris invite you to see this beautiful Built Green® custom home that was featured in the 2011 March/April issue of Yakima Magazine. From the custom tile work to the Norwegian granite counters you will be intrigued with every aspect of this home. This home was built with health, energy efficiency and the environment in mind achieving four star Built Green certification as well as Energy Star® certification.



As you walk into this home you'll be welcomed by the pebble floor bordered by solid bamboo. In the kitchen, the rich dark colors of the exquisite granite countertops contrast nicely against the light colored European style maple cabinets and the stainless steel appliances. The kitchen is completely open to the great room which is surrounded by windows that take in the breathtaking view. The rustic fireplace mantel was hand crafted from local cedar that was salvaged from a burn pile. In the guest bathroom a modern style faucet and a recessed glass sink give an elegant twist to the character of the home. Adventure further and explore the master bathroom's water fall theme tile work that flows from the windows and converge on the floor.

Come see all the custom details of this home and sign up for a drawing to win a free Kindle.

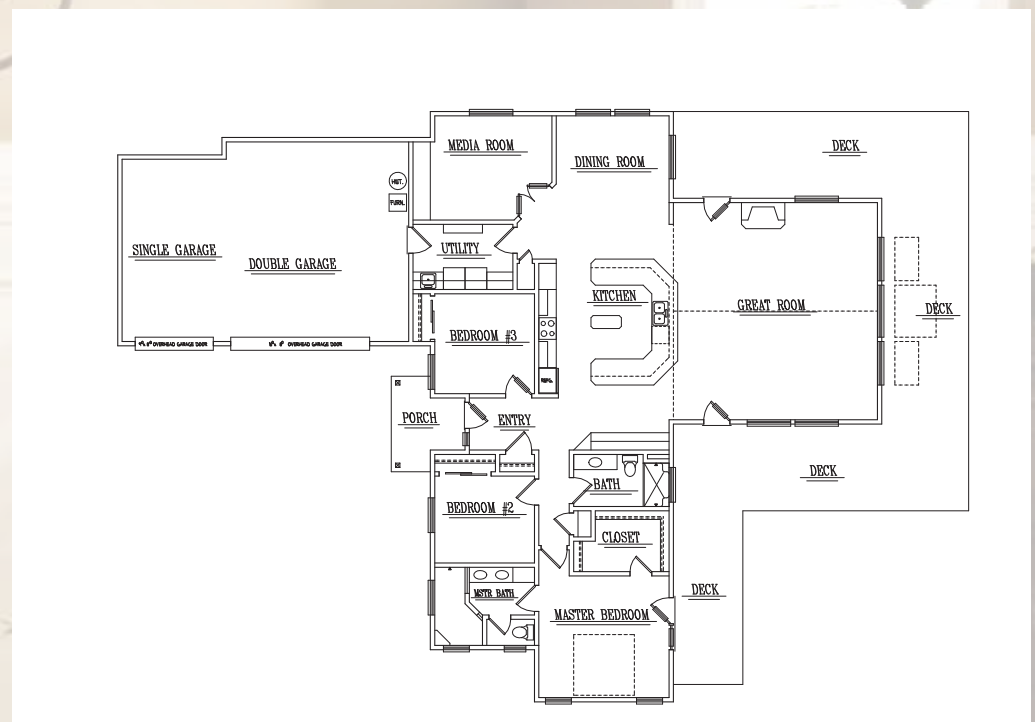

**HARRIS**  
Construction LLC  
harrisconstructionllc.com  
Residential & Commercial



Lynn and Keegan Harris  
509.673.7300  
www.harrisconstructionllc.com  
HARRISCL972MS

Directions: From Highway 12 westbound turn left onto Ackley Rd, just west of the North 40th Exit. Turn right onto West Powerhouse Rd. Turn left onto South Naches Rd. Turn left onto Schuler Grade Rd. Turn right onto Dahl Rd. Turn right on Shannon Rd. Stop at 620.