

# Columbia Ridge 14

Category D

1309 N 13th Street | Selah

Columbia Ridge is pleased to announce new homes in Valhalla Heights, a premier view home community located in the City of Selah.

This hilltop neighborhood is isolated from the surroundings by hundreds of feet, yet all the city features are within a mile. We are currently offering two series of homes in this neighborhood, the Executive Series and the Viewpoint Series.

The Executive Series includes the features shown in our Englewood West tour home located at 7204 Englewood Hill Place, Yakima, while our Viewpoint Series boasts exteriors that include lap siding, shake accents, optional stone veneer and limited lifetime roofing.

The interiors include 9' foot ceilings, stainless steel appliances, wooden doors and trim, and a tasteful color palette throughout. This tour home has an open living space with the kitchen and dining room adjoined to the great room which includes a natural gas fireplace and scenic views of the Yakima River Canyon. The spacious master suite contains a walk in closet and a nice master bath with double vanity sinks and a shower. Upstairs you will find a large bonus room that offers flexible space for your children's or grandchildren enjoyment.

Thank you for visiting Columbia Ridge Homes. For more information, please visit our website at [www.ColumbiaRidgeHomes.com](http://www.ColumbiaRidgeHomes.com)

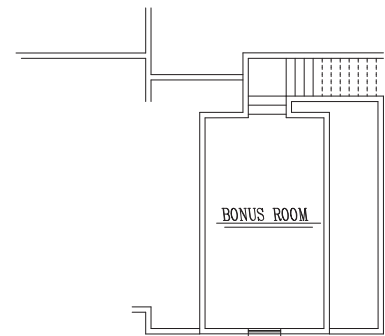
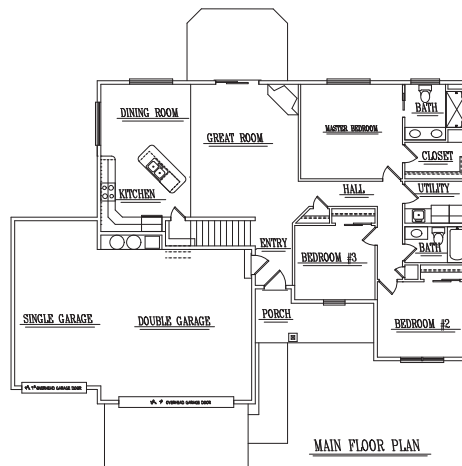

Justin & Brianne Hellem  
(509) 949-6557  
[Justinh@ColumbiaRidgeHomes.com](mailto:Justinh@ColumbiaRidgeHomes.com)  
[www.ColumbiaRidgeHomes.com](http://www.ColumbiaRidgeHomes.com)  
COLUMRH910ML

*Columbia Ridge Homes*



Directions: 1309 N 13th Street traveling on I-82: take exit 30A for WA-823 North, keep straight onto North 1st Street, turn left onto West Goodlander Road, turn right on N 13th Street. 1309 N 13th Street, Selah