

Palazzo Properties 3

Category C

6613 Chestnut Ave. | Yakima

Presented by Palazzo Properties, in the new "Built Green®" sub-division of Mountain View Estates, located close in but nestled in a secluded area of West Valley.

This home features almost 2400 SF, with garage's that will accommodate all your vehicles and toys. Loaded with ten's of thousand's in extra's, supplied at no cost to the purchaser.

Upon your arrival you will be greeted by a bubbling water feature on a fenced and fully landscaped lot, through the eight foot front doors you will find an array of hardwoods, tiles and solid slab granite placed over custom cabinets with self closing drawers and roll out trays. Ten foot ceilings, eight foot solid core doors, a large covered patio with access from the Master Suite, Nook and hall off the "mother-in-law" Suite. Three full baths, four bedrooms, lots of specialty trims and a full stucco exterior. All of this and still under 350k.

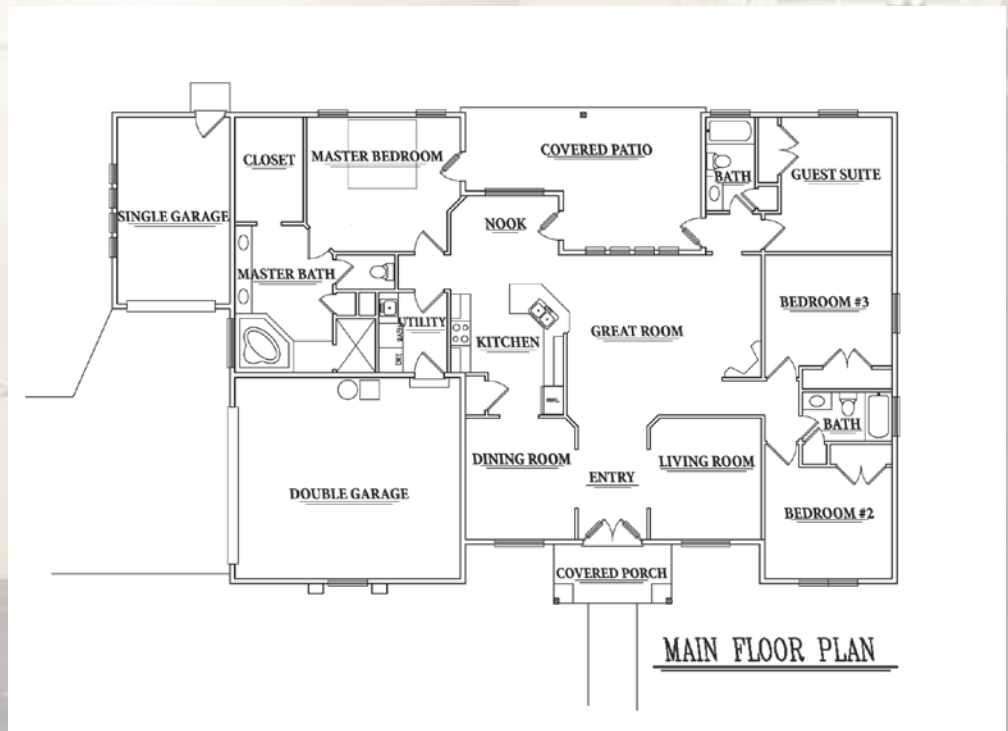

Directions: Head West on Tieton Dr. Take a right on 67th Ave., follow to the stop sign and go straight into Mountain View Estates. 6613 Chestnut Ave.